

DESCRIPTION

Soft 800, 2 Drawer, Wall-Hung Vanity

PRODUCT CODE

FT80D2WH / FT80D2WHM



Dimensions	W 805	x H 620	x D 455	(mm)
Finishes	White Gloss Paint or Melamine			
Basin	Ceramic Integrated Basin & Overflow			
Handle	Handleless Design with Matching Rail (White Gloss or Melamine), or Contrasting Silver or Black Aluminium Rail. Optional pull handle available at additional cost.			
Origin	New Zealand made cabinetry.			
Features	<ul style="list-style-type: none"> • 2 Drawers with soft-close and deeper storage. • Melamine is a wood look, low-pressure laminate. • White Paint - The paint used on our products is polyurethane or UV based. It is harder and more durable than lacquered finishes. 			

TECHNICAL DRAWINGS

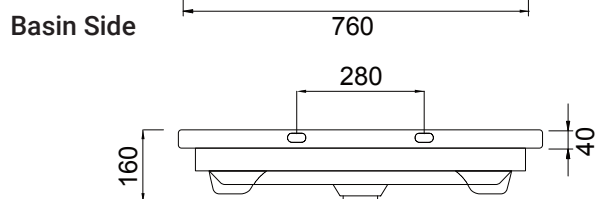
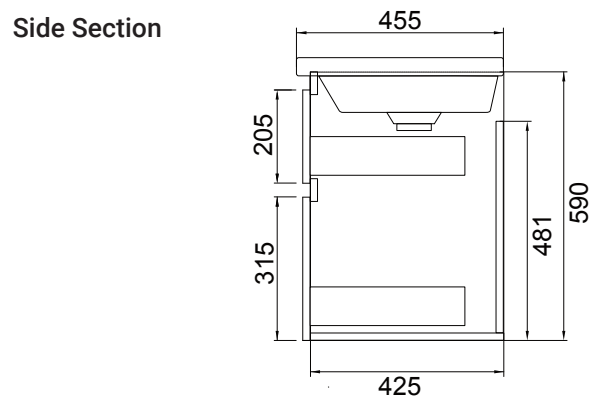
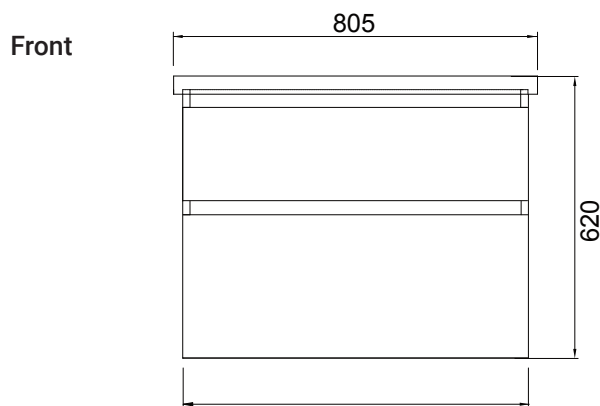
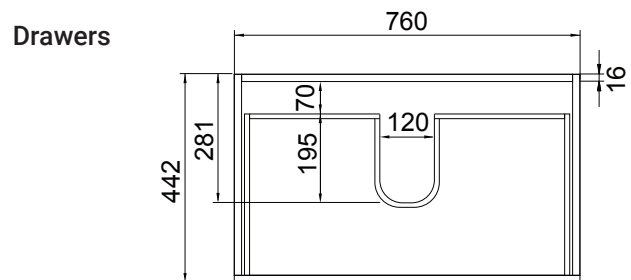
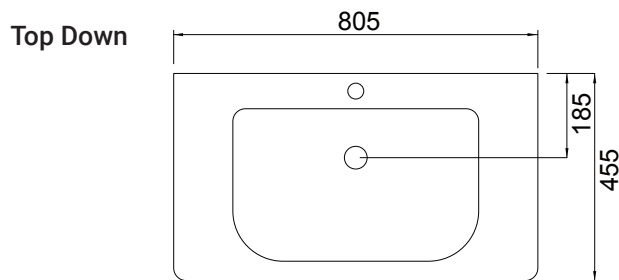

NOTES

*Additional Cost. Accessories not included. Drawing indicates the technical measurement only and is not a reflection of how the product will look. Sizes are nominal only. All drawings in millimeters. Drawings not to scale. August 2023.