

## DESCRIPTION

Zara 900 Wall-Hung Vanity - 2 Drawers, White / Melamine

## PRODUCT CODE

Z90D2WH / Z90D2WHM



## FEATURES

- Dimensions - W 915 x H 468 x D 465mm
- Available in White paint (Gloss) or Melamine
- The paint used on our products is polyurethane or UV based. It is five times harder and more durable than lacquer finishes.
- Timber Effect Melamine: Our wood grain melamine is a low-pressure laminate.
- China basin.
- Soft-close drawers.
- Made to order in NZ.
- Unit includes a top, cabinet and a Box Handle (H1).
- Other handle options include Mini Semi Handle (H4) and Semi Handle (H2).

## MELAMINE / PAINT FINISHES

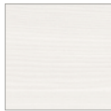

**MNA**  
Nordic Ash



**MDF**  
Driftwood

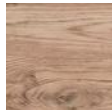

**MFO**  
French Oak



**MME**  
Manhattan  
Elm



**MSO**  
Southern  
Oak



**MHW**  
Hickory  
Walnut

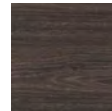

**MBF**  
Black Forest

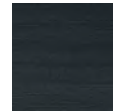

**MCO**  
Charred Oak



**No Code**  
White Paint  
(Gloss)

## TECHNICAL DRAWINGS

See following page.

## NOTES

• Must use bottle traps to ensure drawers open, we recommend 40551-32 bottle trap. • Please use a contoured waste with all basins, we recommend PUW68R waste (slotted for basins with overflow). • Drawing indicates the technical measurement only and is not a reflection of how the product will look. Sizes nominal only. Drawings in millimetres. Not to scale. February 2020.

## DESCRIPTION

Zara 900 Wall-Hung Vanity - 2 Drawers, White / Melamine

## PRODUCT CODE

Z90D2WH / Z90D2WHM

## TECHNICAL DRAWINGS

Top

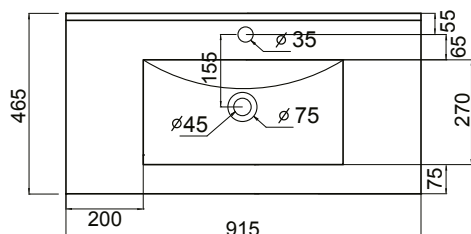

Back

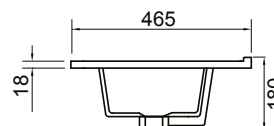

Front

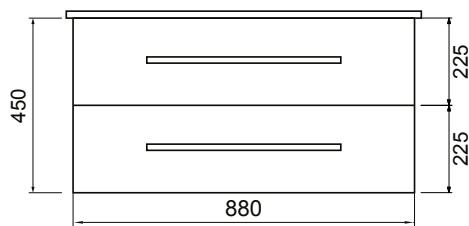

Side Section

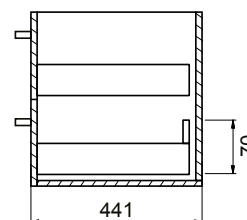

Top Section of Drawer

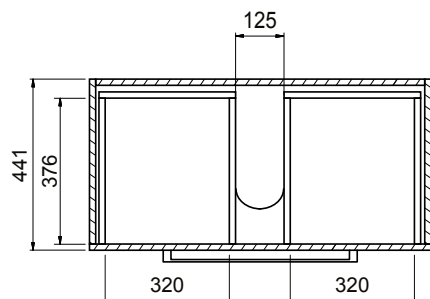

## NOTES

Drawing indicates the technical measurement only and is not a reflection of how the unit will look. Sizes are nominal only. All drawings in millimeters. Drawings not to scale. Feb 2020.